



Business Home Lock

L100 II

Fingerprint & RFID Lock



Stylish, Simple, Secure

L100II is a unique fingerprint lock for every home and office. The latest Anviz fingerprint algorithm makes door open in one second after finger touch. With its simple design, enrollment can be done within 5 seconds. The unique card reader design provides great convenience for the elder and young family members as well as office staff who have cards already. Reversible handle feature can fully meet the DIY installation requirement. Furthermore, L100II utilizes TI chip of low power consumption to ensure 8000 times of door open for 4 AA batteries.

USA **BioNANO**[®]

Core Algorithm V10

Fingerprint - Facial - Iris

Fast fingerprint scan in less than 0.5 second

Waterproof Dustproof Scratchproof Fingerprint Sensor

Easy Installation

99 Fingerprints

Emergency 9v Battery Backup

Reversible handle, DIY design

Infrared activating mechanism

⊗ Feature

- Professional and elegant design by famous designer. Elegant, exquisite, compact and stylish
- Anviz optical fingerprint reader. Scratch-proof, unbreakable and durable. Well accept all kinds of fingerprints
- Strong zinc alloy front panel. Waterproof. Stable and reliable
- intuitive Nixie tube display
- Single latch for easy installation. User can change the handle direction. DIY design
- Independent clutch motor design
- LED indicator and inbuilt musical buzzer
- Identification method: fingerprint, card. Safe and reliable
- Backup mechanical key for emergency open
- Unique RF key design, caring for the elder people and children in your family
- Extendable RFID, Mifare card
- Special free entry design for office. Can be set on the lock when needed during meetings etc.
- USA Ti chip of low consumption. 4 AA batteries for one year (30 times door-open/day)
- Low voltage alarm. 500 door-open still available. External 9V battery for emergency use

⊗ Parameter

Item	Description
Sensor	AFOS300 Optical Sensor
Sensor Wake Up Mode	Infrared
Scan Area	22mm*18mm
Resolution	500 DPI
Fingerprint Capacity	99
Card Capacity	99
Identification Mode	FP, Card, FP+Card
Identification Time	<0.5 Sec
FRR	0.00%
FAR	0.00%
Card Reader Module	Standard 125KHZ EM RFID
Operating Voltage	DC6V (1.5V*4)
Color	Matt silver, Polished Chrome
Case Material	Strong zinc alloy
Size	70(w)*150(h)*80(d)mm
Temperature	-10°C~40°C
Normal Open Mode	Yes
Reversible Handle	Yes
Certificates	FCC, CE
Applicable Situation	99 User

⊗ Typical installation



Enterprise



Hotel



Building



Government



Finance company



Education and training organization

⊗ Outline Drawing

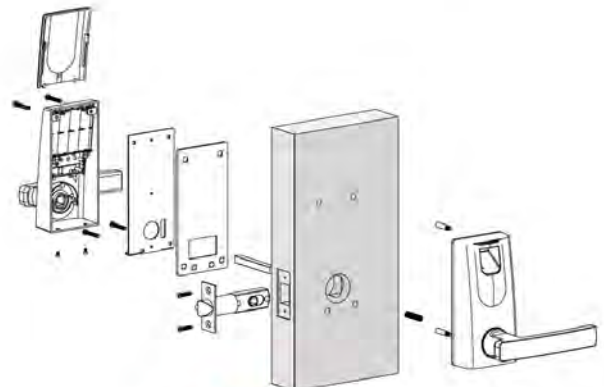
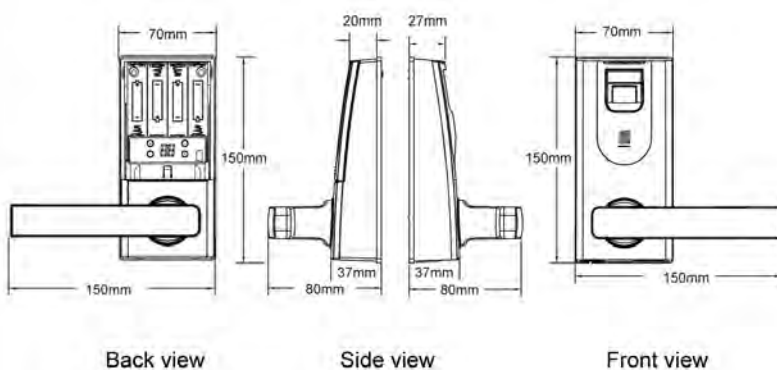

Kimaldi Electronics S.L.

Crta. Rubí 292 B Pol. Ind. Can Guitard
 08228 - Terrassa (Barcelona) Spain
 Tel. +34937361510 - Fax. +34937361511
 kimaldi@kimaldi.com

Kimaldi Lusa Lda.

Rua José Galvão, nº 1- B
 2650 - 219 Amadora - Portugal
 Tel. +351217156303 - Fax. +351217156295
 portugal@kimaldi.com